



PL N 100 FT

PL N 100 FT is a Pure Lead, Long standby battery with excellent performance for applications in telecommunications & UPS. It offers long standby life, high rate performance, low internal resistance and high energy density. It is flame retardant to UL94-V0 and the design is according IEC 60896-21/22:2004

Physical Characteristics		Technical Characteristics	
Nominal Voltage	12V	Internal Resistance	Approx. 4,5 mΩ
Nominal Capacity (10hrs)	100Ah at 180V/cell	Capacity affected by temperature	40C 103%
Dimension LxWxH	405,4x 108 x 287 +/-2mm		25C 100%
Weight	Approx 30,8 kg	0C 86%	Max Discharge Current
Standard Terminal	T11/ M6	1200A (5sec)	

Dimensions

Unit: mm

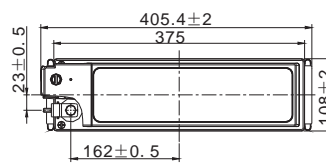
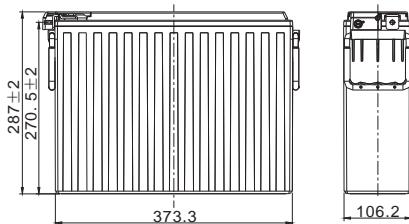

Terminal: M6

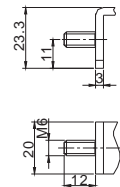

Container Material : A.B.S. UL94-HB

Constant Current & Power Discharge Characteristics: Amperes (25C) / Watts/cell (25C)

Final Voltage	Time	10min	15min	20min	30min	45min	1Hr	2Hr	3Hr	4Hr	5Hr	8Hr	10Hr	20Hr
1,85V/cell	A	193.6	161.5	138.4	110.2	82.6	60.7	39.2	27.8	22.3	18.0	11.9	9.91	5.12
1,80V/cell	A	217.5	180.7	149.8	115.5	87.3	63.3	40.7	29.0	22.6	18.2	12.2	10.0	5.24
1,75V/cell	A	236.7	190.4	160.2	123.1	91.3	65.7	41.9	29.7	23.2	18.4	12.5	10.2	5.30
1,70V/cell	A	252.7	201.4	168.7	128.0	94.6	67.4	42.7	30.2	23.5	18.6	12.6	10.4	5.38
1,67V/cell	A	269.3	209.6	172.9	132.5	96.0	69.2	43.2	30.8	23.7	19.1	12.8	10.8	5.42
1,60V/cell	A	284.4	219.3	179.5	133.8	97.9	70.4	43.5	31.2	23.9	19.4	13.0	11.0	5.51
1,85V/cell	W	367.6	304.7	265.2	217.1	160.6	120.9	75.8	53.9	45.4	37.3	24.7	20.0	10.4
1,80V/cell	W	408.2	337.0	282.7	227.7	166.9	125.6	78.9	57.3	47.0	38.4	25.2	20.3	10.7
1,75V/cell	W	437.9	351.9	293.1	232.4	169.7	127.3	80.8	58.6	47.9	38.8	25.9	20.4	10.8
1,70V/cell	W	466.4	367.5	304.7	239.2	172.9	128.8	81.9	59.3	48.4	39.3	26.1	20.6	10.9
1,67V/cell	W	480.3	384.7	316.0	243.1	177.8	134.3	83.7	60.9	49.3	39.8	26.5	21.3	10.9
1,60V/cell	W	504.1	393.7	324.1	248.2	181.3	136.0	85.4	61.6	50.0	40.3	26.7	21.5	11.0